

Elastomeric springs cellular

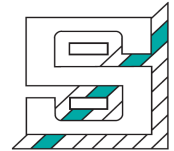

with screw-nut or screw

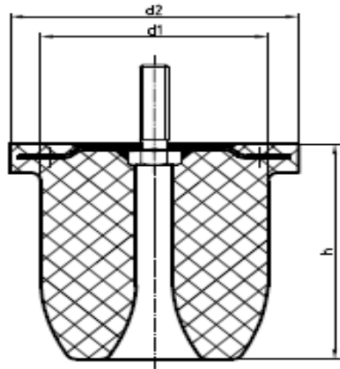

Vulkocell is characterized by outstanding physical and mechanical properties. Therefore it is especially suitable for components exposed to high dynamical stress as used in automotive construction and engineering. Springs made of Vulkocell are deliverable in various densities.

Important properties:

- increasing energy absorption with increasing density
- steady compression behaviour
- low permanent deformation under endurance stress
- high volume compressibility with minimal transverse expansion
- high deflexion on less height
- grease-, oil- and ozon resistant
- temperature range -30°C to +80°C

NOTE:

Load values are available on request.

Item-No. *		Dimensions d1 x d2 x h in mm
with screw-nut	with screw	
254100055	254100155	Ø 50/ 60 x H 41
254101055	254101155	Ø 50/ 60 x H 51
254102055	254102155	Ø 50/ 60 x H 61
254103055	254103155	Ø 50/ 60 x H 66
254104055	254104155	Ø 50/ 60 x H 76
254105055	254105155	Ø 63/ 80 x H 51
254106055	254106155	Ø 63/ 80 x H 64
254107055	254107155	Ø 63/ 80 x H 76
254108055	254108155	Ø 63/ 80 x H 84
254109055	254109155	Ø 63/ 80 x H 96
254110055	254110155	Ø 80/ 95 x H 66
254111055	254111155	Ø 80/ 95 x H 81
254112055	254112155	Ø 80/ 95 x H 96
254113055	254113155	Ø 80/ 95 x H 106
254114055	254114155	Ø 80/ 95 x H 126
254115055	254115155	Ø 100/ 120 x H 81
254116055	254116155	Ø 100/ 120 x H 101
254117055	254117155	Ø 100/ 120 x H 121
254118055	254118155	Ø 100/ 120 x H 133
254119055	254119155	Ø 100/ 120 x H 151
254120055	254120155	Ø 112/ 135 x H 91
254122055	254122155	Ø 112/ 135 x H 131
254123055	254123155	Ø 112/ 135 x H 151
254124055	254124155	Ø 112/ 135 x H 171

Item-No. *		Dimensions d1 x d2 x h in mm
with screw-nut	with screw	
254125055	254125155	Ø 125/ 145 x H 101
254126055	254126155	Ø 125/ 145 x H 125
254127055	254127155	Ø 125/ 145 x H 151
254128055	254128155	Ø 125/ 145 x H 166
254129055	254129155	Ø 125/ 145 x H 191
254130055	254130155	Ø 140/ 165 x H 111
254131055	254131155	Ø 140/ 165 x H 141
254132055	254132155	Ø 140/ 165 x H 166
254133055	254133155	Ø 140/ 165 x H 186
254134055	254134155	Ø 140/ 165 x H 210
254135055	254135155	Ø 160/ 185 x H 131
254136055	254136155	Ø 160/ 185 x H 161
254137055	254137155	Ø 160/ 185 x H 185
254138055	254138155	Ø 160/ 185 x H 211
254139055	254139155	Ø 160/ 185 x H 240
254140055	254140155	Ø 180/ 210 x H 146
254141055	254141155	Ø 180/ 210 x H 181
254142055	254142155	Ø 180/ 210 x H 211
254143055	254143155	Ø 180/ 210 x H 241
254144055	254144155	Ø 180/ 210 x H 271
254145055	254145155	Ø 200/ 230 x H 161
254146055	254146155	Ø 200/ 230 x H 201
254147055	254147155	Ø 200/ 230 x H 236
254148055	254148155	Ø 200/ 230 x H 266
254149055	254149155	Ø 200/ 230 x H 301

* Item-No. are valid for material Vulkocell NH 24 - 50. For other materials it would change. Please note requested density on your order to avoid any misunderstandings.

P+S Polyurethan-Elastomere



P+S Polyurethan-Elastomere
GmbH & Co.KG

Kielweg 17
49393 Diepholz

telephone 05441 / 5980-0
fax 05541/ 5980-88

eMail: info@pus-polyurethan.de
website: www-pus-polyurethan.de